

EB68

100% by the Italian design team took three years to design, the tire balancing machine once again



Optional



EB68

Line Drawing

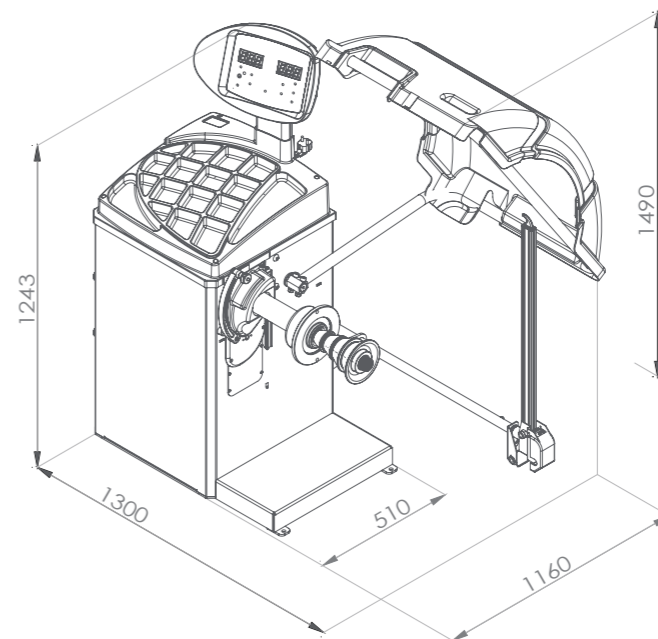

Product description

Ultra-high cost performance, three value automatic input. Intelligent switching between "STD" and "ALS2", electromagnetic positioning brake, six o'clock laser light indicator, ergonomic lead mode

Product feature

- Italian software, simple operation
- Three value automatic input
- 40mm balancing shaft
- Motorcycle mode, optional motorcycle clamp
- LED light
- Electromagnetic positioning brake
- Six o'clock laser indicating function
- Intelligent switch dynamic STD/ Aluminum Alloy ALS2

Technical data

Rim diameter	1" - 28"
Max wheel weight	70 kg
Max wheel diameter	1118 mm
Rim width	1,5" - 20"
Precision	±1g
Motor Power	90W
Power supply	100/230V 1ph
Rotation	140rpm
Balancing time	7s
Second test	≤5g
Machine dimensions	1550x1160x1243 mm
Packing dimensions	1070x760x1150 mm
Net weight	132 kg
Gross weight	170kg
Qty in 40FT	66 sets

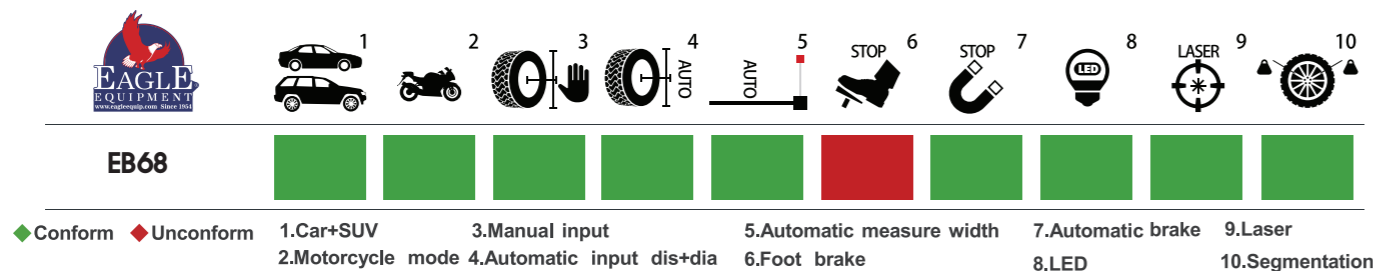

EB68

◆ Conform ◆ Unconfirm

1. Car+SUV 2. Motorcycle mode 3. Manual input 4. Automatic input dis+dia 5. Automatic measure width 6. Foot brake 7. Automatic brake 8. LED 9. Laser 10. Segmentation