



COMMANDER

1,000 LBS. CAPACITY
MOTORCYCLE LIFT

INSTALLATION & OPERATION MANUAL

REV200801.0 BD

INTRODUCTION

Thank you for your purchase.

Your lift is the result of decades of research, testing and development; and represents the most advanced technology on the market.

The care with which you maintain and operate your lift will directly affect its overall performance and longevity.

BE SAFE

Your lift was designed and built with safety in mind. However, safety relies on proper training and thoughtful use on the part of the operator. DO NOT operate or repair this equipment without reading this manual and the important safety instructions shown inside.

Keep these instructions accessible, and make sure that ALL USERS read this manual.



READ THIS ENTIRE MANUAL
CAREFULLY AND COMPLETELY
BEFORE INSTALLATION
OR OPERATION OF THE LIFT.



TRANSPORTATION

A motorcycle lift is a heavy piece of equipment. A fork-lift or other similar mechanism is necessary for its loading, off-loading and movement. Upon arrival, customer is responsible for unloading and receiving the lift from the freight carrier. Customer's site must be accessible to the freight carrier.

SHIPPING AND DAMAGE CLAIMS

INSPECT YOUR LIFT UPON DELIVERY. NOTE ANY DAMAGE ON DELIVERY RECEIPT.

When this equipment is shipped, title passes to the purchaser upon receipt from the carrier. Consequently, claims for the material damaged in shipment must be made by the purchaser against the transportation company at the time shipment is received.

UNPACKING and SET-UP

- 1] Your lift comes packaged as a single unit. A fork-lift, floor-jack or other heavy-lifting equipment may be necessary to separate the components. Exercise caution when disassembling the packaged lift, as shifting may have occurred during shipping.
- 2] Carefully unpack the lift. Check for any obvious shipping damage. (Remember to report any shipping damage to the carrier and make a notation on the delivery receipt.)
- ⚠ 3] Carefully turn the table upright into operating position before removing shipping cable restraint from scissor mechanism.
- ⚠ 4] Connect foot-operated air valve to 100 psi maximum air supply. The lift may be damaged and/or personal injury may result if the pressure exceeds the maximum 100 psi rating.
- 5] Stand clear of lift table, and depress the “UP” side of the foot valve to raise the table.
- 6] To lower table, lift locking bar from safety latch and lower to next position, or to the floor.
- 7] Place drop-out cover over drop out opening.
- 8] Insert ramp mounting pins into holes at either end of table to mount ramp.

NOTE: If cycle vise is being installed, ramp must be mounted opposite the cycle vise.

OPERATION and MAINTENANCE

- ⚠ 1] Loads must be centered on table at all times. Table is rated for a maximum load of 1,000lbs.
- ⚠ 2] Loads must be firmly positioned and secured on table at all times.
- 3] All moving parts have been lubricated at the factory and should be re-lubricated every six (6) months to prevent problems. Grease points are located at each end of frame pivot shaft and at top ends of inside frame assembly.
- 4] Lightly oil cylinder rod when it becomes dry.
- 5] Squirt some oil through bleed hole in plate end of cylinder to lubricate piston and its seal every six (6) months.
- 6] Pivot shaft set screws should be checked frequently to be sure they are tight. These are located at the top end of the inside frame assembly.



(Fig. 1)

For assistance, please call: 1-800-535-0016

PARTS LISTING*

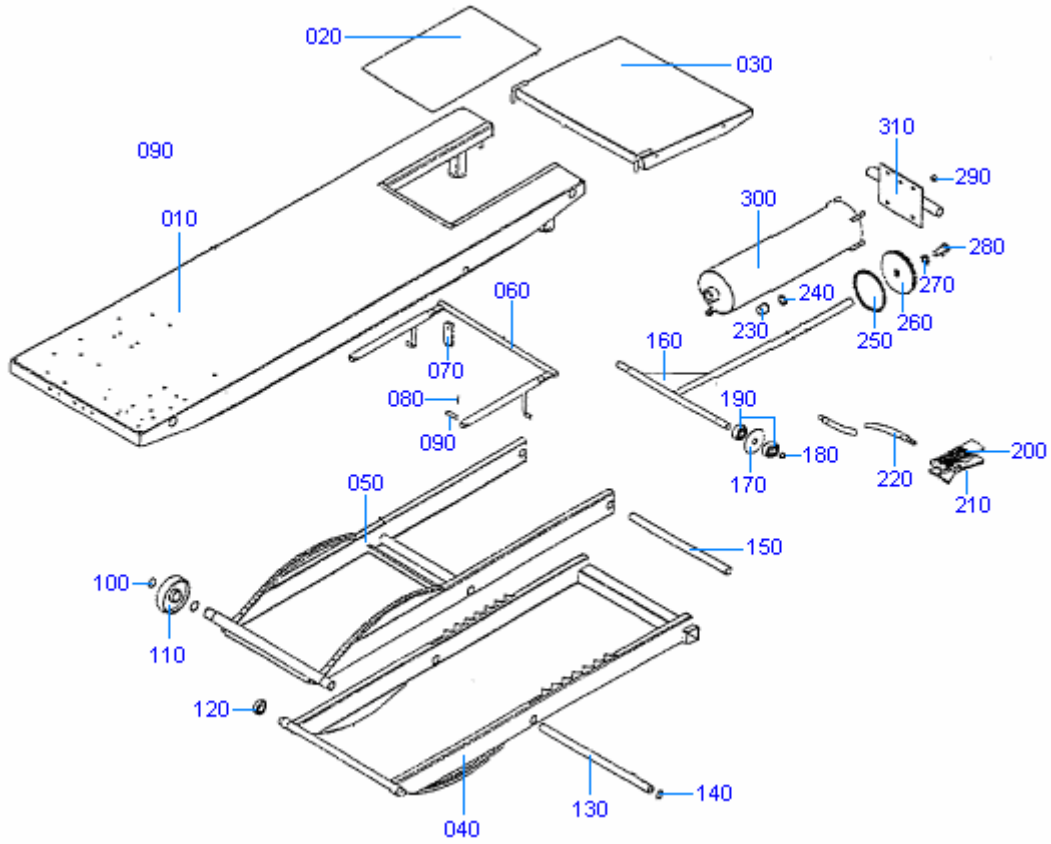

010	Table	170	Roller Spacer
020	Rear Wheel Drop-Out	180	Retaining Ring
030	Ramp	190	Roller Bearing
040	Frame Assembly (Outside)	200	Pedal Assembly
050	Frame Assembly (Inside)	210	Valve Stem Assembly
060	Safety Lock Bar	220	Valve Hose w/ Fitting
070	Clip	230	Cylinder Shaft Bushing
080	Cotter Pin	240	Cylinder Shaft Seal
090	Clevis Pin	250	Piston Seal
100	Retaining Ring	260	Piston
110	Wheel	270	Lock Washer
120	Track Roller Bearing	280	Screw
130	Frame Pivot Shaft	290	Retaining Ring
140	Retaining Ring (1-1/4")	300	Cylinder
150	Cylinder Pivot Shaft	310	Cylinder End Plate
160	Cylinder Shaft Assembly		

*Illustration for reference purposes only.
 Availability subject to change without notice.
 Certain items available as components, only.

IMPORTANT SAFETY INSTRUCTIONS

Read These Safety Instructions Thoroughly

1. Read and understand all operation & safety warning procedures before operating lift.
2. Keep hands and feet clear. Remove hands and feet from any moving parts. Keep feet clear of lift when lowering. Avoid pinch points.
3. Keep work area clean. Cluttered work areas invite injuries.
4. Consider work area environment. Do not expose equipment to rain. Do not use in damp or wet locations. Keep area well lighted.
5. Only trained personnel should operate this lift. All non-trained personnel should be kept away from the work area. Never let non-trained personnel come in contact with, or operate lift.
6. Use lift correctly. Use lift in the proper manner. Never use lifting adapters other than those provided by the manufacturer, in any manner other than intended.
7. Do not override self-closing controls.
8. Remain clear of lift when raising or lowering vehicle.
9. Clear area if vehicle is in danger of falling.
10. Always insure that the safeties are engaged before any attempt is made to work on or near vehicle.
11. Dress properly. Non-skid, steel-toe foot-wear is recommended when operating lift.
12. Guard against electric shock. This lift must be grounded while in use to protect the operator from electric shock. Never connect the ground wire to a live terminal. This is for ground only.
13. Maintain with care. Keep lift clean for better and safe performance. Follow manual for proper lubrication and maintenance instructions. Keep control handles and/or buttons dry, clean and free from grease and oil.
14. Stay alert. Watch what you are doing. Use common sense. Be aware.
15. Check for damaged parts. Check alignment of moving parts, breakage of parts or any condition that may affect its operation. Do not use lift if any component is broken or damaged.
16. Never remove safety related components from the lift. Do not use lift if safety related components are damaged or missing.



Eagle Global Series Warranty

Eagle Equipment warrants to the original retail purchaser of an Eagle Global Tire Changer or Wheel Balancer that it will replace without charge any part found under normal use, in the United States or Canada, to be defective in materials or workmanship, **for a period of one (1) year from date of purchase**. Warranty covers parts only; purchaser is responsible for any and all labor requirements.

Exclusions

This warranty will not apply to any machine:

1. Which has not been operated or maintained according to specifications
2. Which has been abused, misused, altered or improperly maintained
3. Which has been improperly installed or assembled

Other limitations

This warranty does not cover:

1. Parts needed for normal maintenance
2. Wear parts, which include but are not limited to, speed-nuts, cones, mount heads, and inserts
3. On-site labor

Eagle Equipment reserves the right to make improvements and/or design changes to its equipment without any obligation to previously sold, assembled or fabricated equipment.

There is no other express warranty on the Eagle Global Series equipment and this warranty is exclusive of and in lieu of all other warranties, expressed or implied, including all warranties of merchantability and fitness for a particular purpose.

To the fullest extent allowed by law, Eagle Equipment shall not be liable for loss of use, inconvenience, lost time, commercial loss or other incidental or consequential damages

Some States do not allow exclusion or limitation of consequential damages or how long an implied warranty lasts, so that the above limitations and exclusions may not apply. This warranty gives you specific legal rights and you may have other rights, which may vary from State to State.